

# ROC235B

PERFECTRON

19" 1U Rack-mount Intel® QM77 Fanless Rugged System with Intel® Core™ i7/i5/i3 Processors, 100V to 240V AC-in, Wide Temp. -20 to 60°C

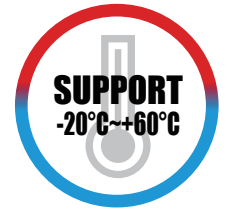

## Main Features

- Supports Intel® 22nm Ivy Bridge Processor i7-3610QE/i5-3610ME/i3-3120ME
- 2 x DDR3 SO-DIMM up to 16 GB
- Supports 2 x 2.5" Easy Swap SSD
- Multi-display: 1 x DVI-D, HDMI, VGA
- Dual GbE LAN ports
- 4 x USB 3.0 / 2 x USB 2.0
- 100V ~ 240V AC-in

## ► Specifications

### System

CPU	Intel® 22nm Ivy Bridge Processor (Mobile) socket (rPGA988) Core™ i7-3610QE (4C x 3.3 GHZ), 6M L2 cache (45W) Core™ i5-3610ME (2C x 2.7 GHZ), 3M L2 cache (35W) Core™ i3-3120ME (2C x 2.4 GHZ), 3M L2 cache (35W)
Chipset	Intel® QM77
Memory	2 x 204-pin SO-DIMM DDR3 1333/1600 MHz up to 16 GB
Expansion Slot	1 x PCI 1 x Mini PCIe
Storage Device	2 x 2.5" Easy Swap SSD

### Front I/O

Power Button	Yes
Power LED	Yes
HDD LED	Yes
USB	2 x USB 2.0
Reset	Yes

### Rear I/O

VGA	1
DVI-D	1
HDMI	1
Ethernet	2 x RJ45
Audio	Mic-in, Line-out
COM	1 x RS232/422/485
USB	4 x USB 3.0

### Mechanical & Environment

Power Requirement	100V to 240V AC-in
Dimension (W x H x D)	440 x 44 x 380 mm (17.32" x 1.73" x 14.96")
Operating Temp.	-20 to 60°C (ambient with air flow)
Storage Temp.	-20 to 80°C
Relative Humidity	10% to 90%, non-condensing
Certifications	CE, FCC

## ► Mechanical Drawing

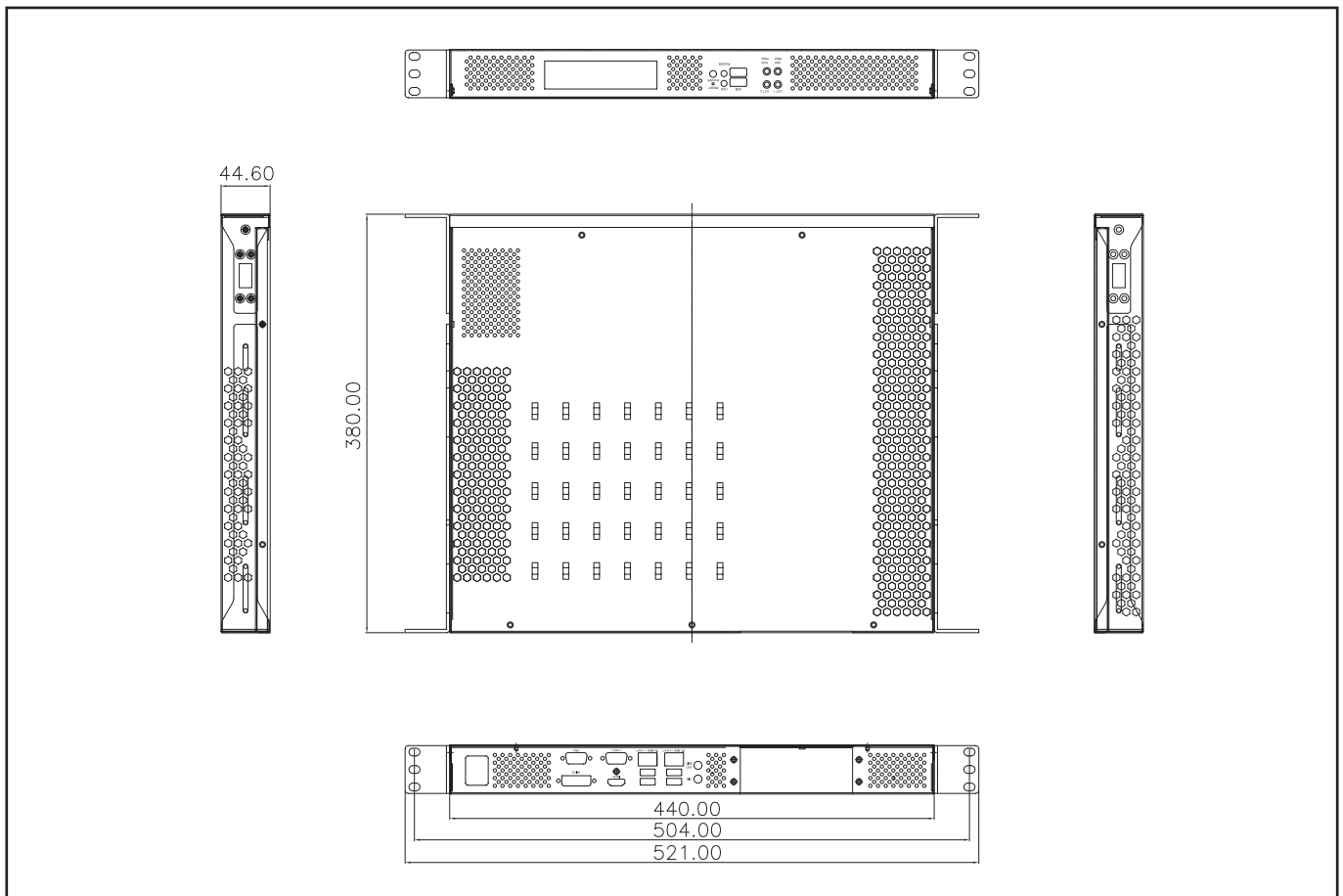

## ► Packing List

- ROC235B Fanless Rugged System
- Driver CD

## ► Ordering Information

### Modules

Model Number	Description
ROC235B-ET-i7-3610QE	Intel® QM77 Fanless Rugged System with Intel® Ivy Bridge Core™ i7 Processor, 100V to 240V AC-in (-20 to 60°C)
ROC235B-ET-i5-3610ME	Intel® QM77 Fanless Rugged System with Intel® Ivy Bridge Core™ i5 Processor, 100V to 240V AC-in (-20 to 60°C)
ROC235B-ET-i3-3120ME	Intel® QM77 Fanless Rugged System with Intel® Ivy Bridge Core™ i3 Processor, 100V to 240V AC-in (-20 to 60°C)

